

INSTALLATION INSTRUCTION

WIFI SPIKE LIGHT

TECHNICAL DATA

MODEL	VT-5167	VT-5168
POWER	7W	7Wx3
MODULE POWER	5.2W	5.2Wx3
VOLTAGE	AC:220-240V, 50/60Hz	
MODULE VOLTAGE	DC:24, 7V	DC:24, 7V
CURRENT	21MA	21MA
MODULE CURRENT	52MA	52MA
LUMEN	520LM	520LMx3
MODULE LUMEN	700LM	700LMx3
BEAM ANGLE	70°	70°
MODULE BEAM ANGLE	SPHERE 360°	SPHERE 360°
DIMENSION	232x140mm	232x140mm
LIFE SPAN	25,000 Hours	25,000 Hours
BODY TYPE	PC	PC



INTRODUCTION & WARRANTY

Thank you for selecting and buying V-TAC SMART LED Lighting. V-TAC will serve you the best. Please read these instructions carefully before starting the installation and keep this manual handy for future reference. If you have any other query, please contact our dealer or local vendor from whom you have purchased the product. They are trained and ready to serve you at the best. The warranty is valid for 2 years from the date of purchase. The warranty does not apply to damage caused by incorrect installation or abnormal wear and tear. The company gives no warranty against damage to any surface due to incorrect removal and installation of the product. The products are suitable for 10-12 Hours Daily operation. Usage of product for 24 Hours a day would void the warranty. This product is warranted for manufacturing defects only.

IN CASE OF ANY QUERY/ISSUE WITH THE PRODUCT, PLEASE REACH OUT TO US AT: SUPPORT@V-TAC.EU
FOR MORE PRODUCTS RANGE, INQUIRY PLEASE CONTACT OUR DISTRIBUTOR OR NEAREST
DEALERS. V-TAC EUROPE LTD. BULGARIA, PLOVDIV 4000, BUL.L.KARAVELOW 9B

SAFETY WARNING

1. Please make sure to turn off the power before starting the installation.
2. Installation must be performed by a qualified electrician
3. Do not exert external force or throw on the lamp.
4. Lamps should be stored in cool/dry place. Always make sure the environment is clean before installing the lamp.
5. Do not discard the lamps with regular trash. Lamps are made with electronic components and should be properly disposed at designated locations with unified treatment like traditional electronic equipment.

NOTE:

1. This device requires Wi-Fi Frequency 2.4Ghz
2. Operating frequency (maximum transmitted power) 2400MHz -2483.5MHz (20dBm)



This marking indicates that this product should not be disposed of with other household wastes.



MULTI-LANGUAGE MANUAL QR CODE

Please scan the QR code
to access the manual in
multiple languages.



APP INSTALLATION

- Step 1: Disconnect the power supply and install the lamp.
Step 2: Turn the power ON to test the lamp.
Step 3: Enable WI-FI and bluetooth on your phone device.
Step 4: Scan the given QR code, or download "V-TAC Smart Light" from the App Store (iOS)
or the Google Play Store (Android).

For ANDROID



For IOS



Step 5: Open the V-TAC Smart Light app and tap on register for creating a new account.

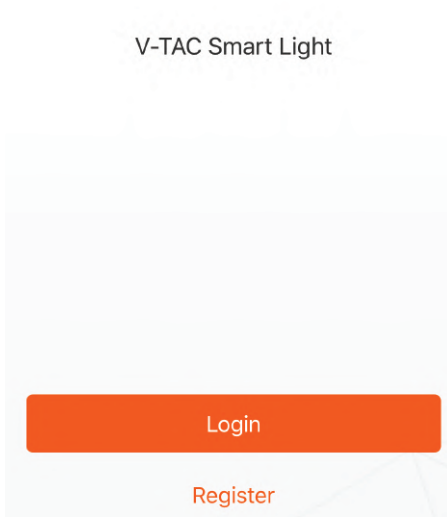

Step 6:

A) Mobile Number: Select the country, then enter your mobile number. Once done, tap 'Next'.

B) E-Mail: Enter your email id and tap on 'Next'.

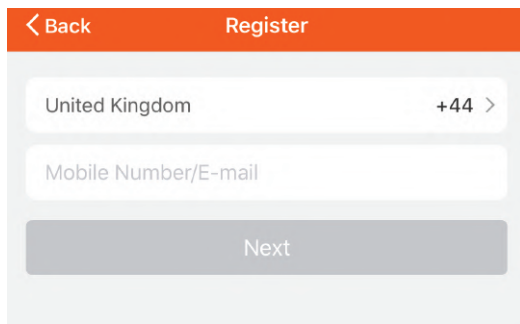

Step 7: Enter the verification code which will be sent to your mobile number/email id, then assign a new password to your account and tap on "Confirm".

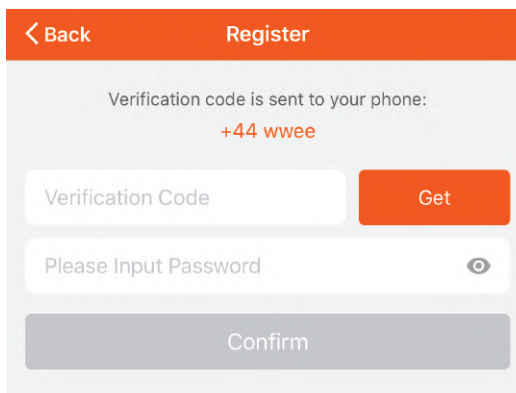

Step 8: Tap on 'Add Device' or the + sign. Make sure the lamp is switched on.

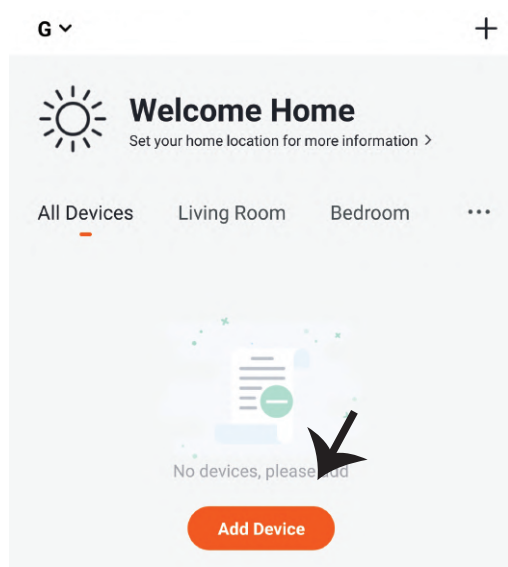



V-TAC Smart Light Bulb offers two types of pairing modes:

- 1) EZ Mode - Light flashes rapidly
- 2) AP mode - Slow Flash or long brightness

Step 1: Switch ON the bulb, if the light is flashing rapidly the device is in EZ mode. Please proceed to pairing the smart device with the App. If not please follow Step 2.

Note: Each time you switch the device OFF-ON repeatedly 3 times with short intervals of less than 2 seconds the pairing mode of the device alternatively switches between EZ mode and AP mode.

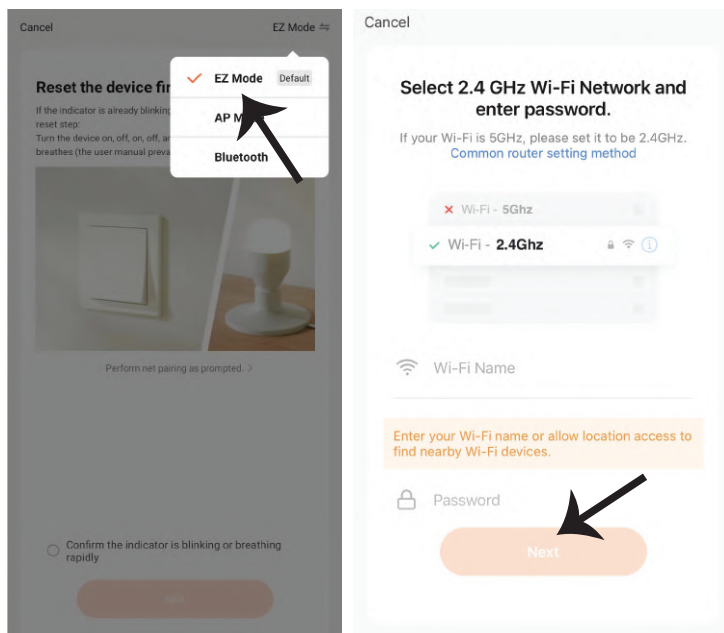

Step 11: Once you have successfully completed step 10, you will be redirected to below page, where the App searches, registers and initializes the device(lamp) (ref image below).

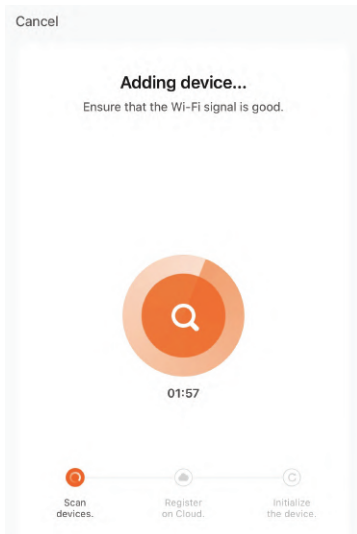

Step 12: Once your device is successfully added, rename the device to your preference.

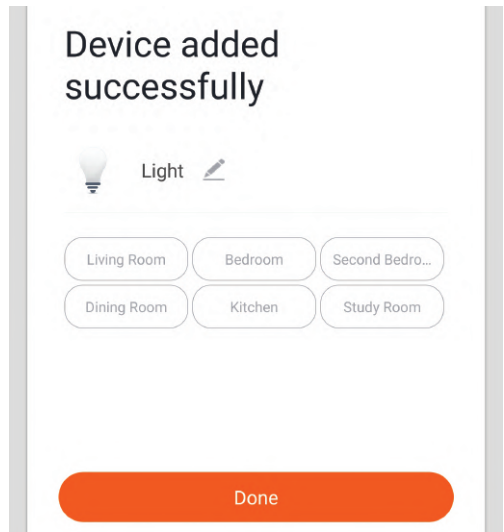

Step 13: After successfully pairing the lamp with the app, you can start controlling multiple features of the lamp through your mobile– on/off switch, changing the colour temperature, timing & schedules, dimming options, and more.

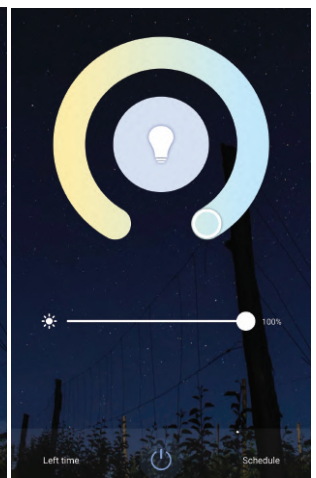
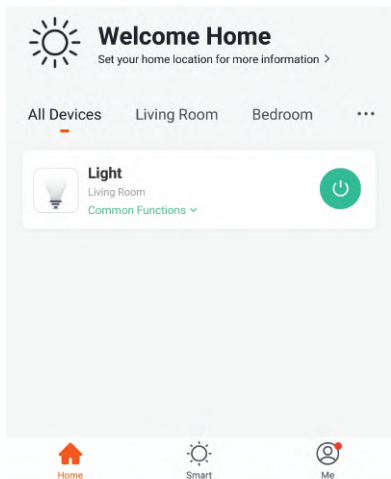

ALEXA SETTINGS

Step 1: Install the Amazon Alexa app via the App Store (iOS) or the Play Store (Android) and register. If you already have an existing account with Amazon Alexa, please proceed to logging in.

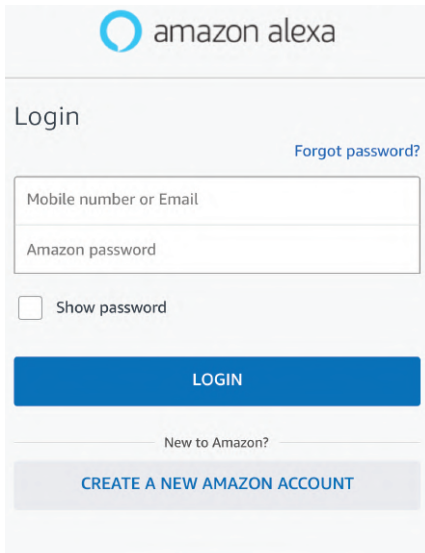

The screenshot shows the Amazon Alexa app's login interface. At the top is the Amazon Alexa logo. Below it is a 'Login' section with a link for 'Forgot password?'. There are two input fields: 'Mobile number or Email' and 'Amazon password'. A checkbox labeled 'Show password' is below the password field. A blue 'LOGIN' button is at the bottom of the login section. Below the login button is a link for 'New to Amazon?' and a button labeled 'CREATE A NEW AMAZON ACCOUNT'.

Step 2: Once you are on the Amazon Alexa home page, tap on the lower right icon — where the arrow is pointed — to add a new device and skill.

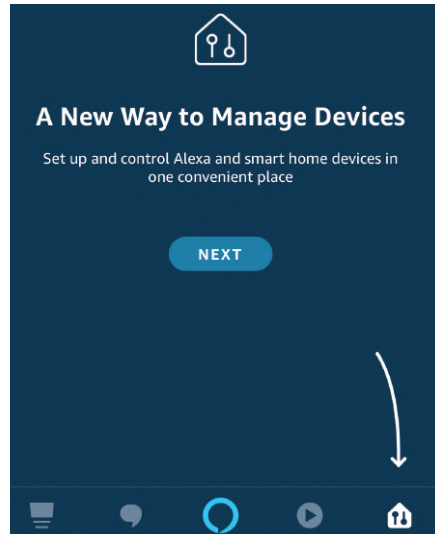

Step 3: Tap on  settings and tap on “skills and games” as shown below.

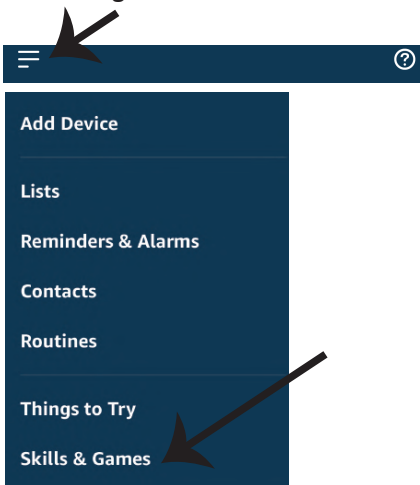

Step 4: Search for ‘V-TAC Smart Light’ on the “Skills & Games” page as shown below.



Search

Keyword or skill name
V-TAC Smart Light

Step 5: Enable the Skill.



Step 6: Enter your V-TAC Smart Light login ID and password and tap on "Link Now"

A login form with two input fields. The first field contains a US flag icon, a "+1" country code, a dropdown arrow, and the placeholder text "Phone Number/Email Address". The second field contains the placeholder text "Type your password here" and an eye icon for toggling password visibility. Below the fields is a grey button labeled "Link Now". At the bottom, there are two links: "Forgot Password" on the left and "Help" on the right.

Step 7: Once you tap on Link Now, you will be redirected to a new page requesting for authorization(Ref Image below). Tap on "Authorize"



Alexa by Amazon will be able to:

- Receive your public profile
- Control your devices over internet

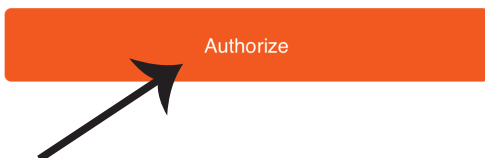

Step 8: You will receive confirmation of the account being linked successfully (Ref Image below)

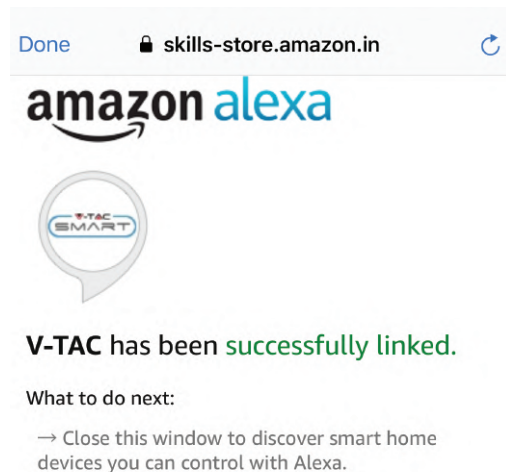

Step 9: Discover your smart device on Alexa. Once you have enabled the skill

A) You can use voice command "Alexa discover devices" to the Alexa device which you have.

B) To add device manually on home page tap on  and tap on Add device , select the device which you are adding and tap on discover device.

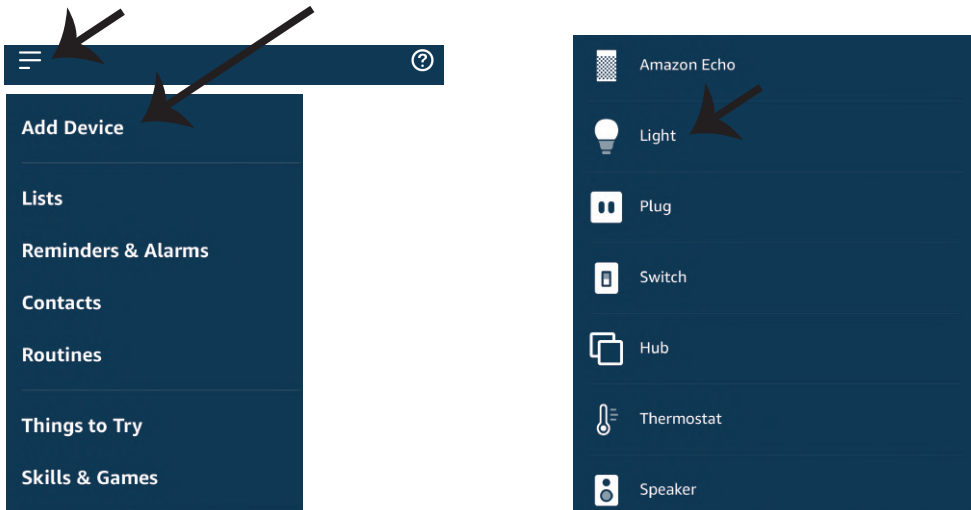

Note: Discovering the device must be done every time the device's name is changed on the app.

ALEXA Commands

Now, you can control your smart device using voice commands on Alexa.

Below are a few commands you can use:

- ! Alexa, turn on/off bedroom light.
- ! Alexa, set bedroom light to 50 percent.
- ! Alexa, set bedroom light to green.
- ! Alexa, set bedroom light to warm white.

THINGS TO REMEMBER BEFORE STARTING INSTALLATION:

1. V-TAC Smart Light App & Amazon Alexa App
 2. Make sure you have Amazon Alexa Device(including Echo, Echo Tap, or Echo Dot)
 3. Smart Device - Lamp
 4. Stable Wifi network
-

GOOGLE HOME SETTINGS

Step 1:

- a&b) Install the Google Home app via the App Store (iOS) or the Play Store (Android) and register. If you already have an existing account with Google Home, please proceed to logging in.
- c) Create a New Home/Choose from the existing home if any.
- d) Power ON the Google Home device and connect it to the App.(Then Proceed to step 2)

a. Welcome home

Your content and devices all in one place



[GET STARTED >](#)

b. Choose account

This account will be used to personalize your experience

c. Choose a home

You will be able to control the devices and services in this home.



Create another home

d. Plug in your device

Make sure your device is nearby and connected to power, then try again

Step 2: Once you are on the Google home page, tap on the Add “+” icon– to add a new device and skill. And then tap on Set up device as shown in below image.

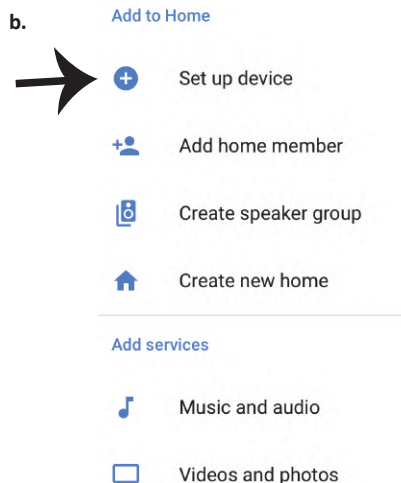
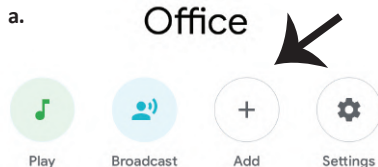

Step 3: Make sure the Smart Bulb is paired with V-TAC Smart Light app before starting step 3. Tap on the arrow section as highlighted in the below image.

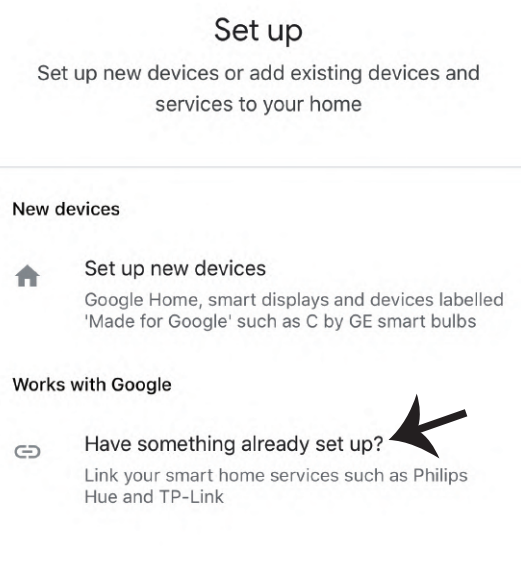

Step 4: Type “V-TAC Smart Light” on the search bar and tap on the icon of “V-TAC Smart Light”

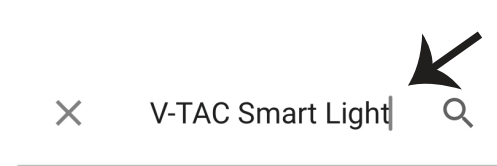

Step 5: Sign In with your V-TAC Smart Light Login credentials to Link the Smart Light device

+1

▼

Phone Number/Email Address

Type your password here

Link Now

Forgot Password

Help

Step 6: Tap on Authorize in order to proceed to linking the device.

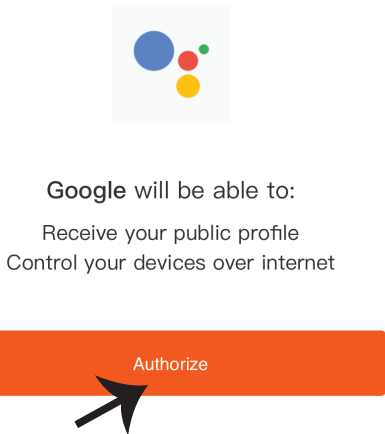

Step 7

a. Account will now be linked, please stay on the page you will be redirected in few seconds to select the device to add to your home.

b. Select the device and tap on Next as show in image b.

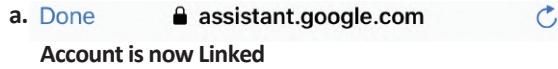

b. ✕ Choose device

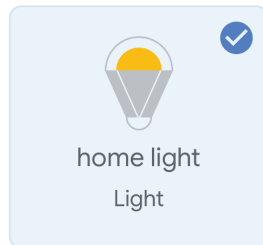

Step 8: Select the Home where you would like to add the Smart Light under. (Or) you can create a New home in order to add the Smart Light to it.

Choose a home

You will be able to control the devices and services in this home.

- ☒ Smart-Home
- ☐ Office
- ☐ Smart Home
- ☐ Create another home

Step 9: You have succesfully added Smart Light device to your Google home App.

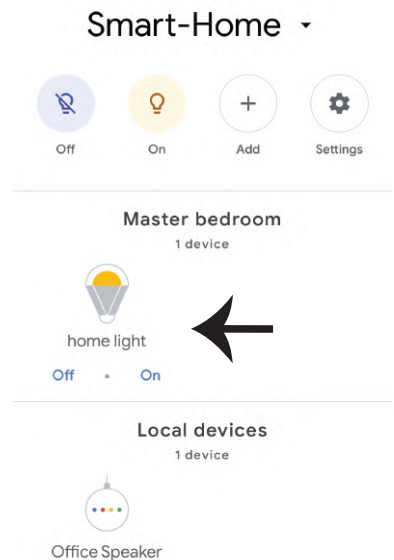

Step 10:

- You can turn the Lamp On/OFF by tapping on On/Off options as shown below. (OR) You can tap on the Smart Lamp.
- You will be redirected to page(as shown in image b) where you can control the lights "Power and Dimming functionality".

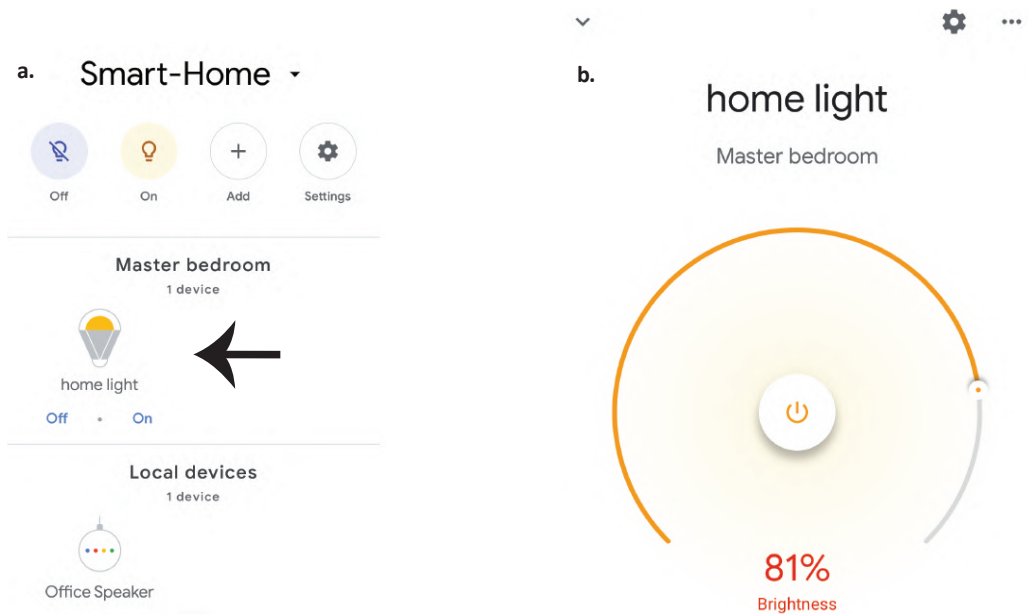

Google Commands:

Now, you can control your smart device using voice commands on Google Home.

Below are a few commands you can use:

- ! Ok, Google, turn on/off bedroom light
- ! Ok, Google, set bedroom light to 50 percent.
- ! Ok, Google, set bedroom light to green.
- ! Ok, Google, set bedroom light to warm white.

THINGS TO REMEMBER BEFORE STARTING INSTALLATION:

1. V-TAC Smart Light App & Google Home App
2. Make sure you have Google Home Device
3. Smart Device - Lamp
4. Stable Wifi network

STEPS TO DISSASSEMBLE THE LAMP (ONLY FOR MARKET SURVEILLANCE AUTHORITY)

DISASSEMBLING DIAGRAM

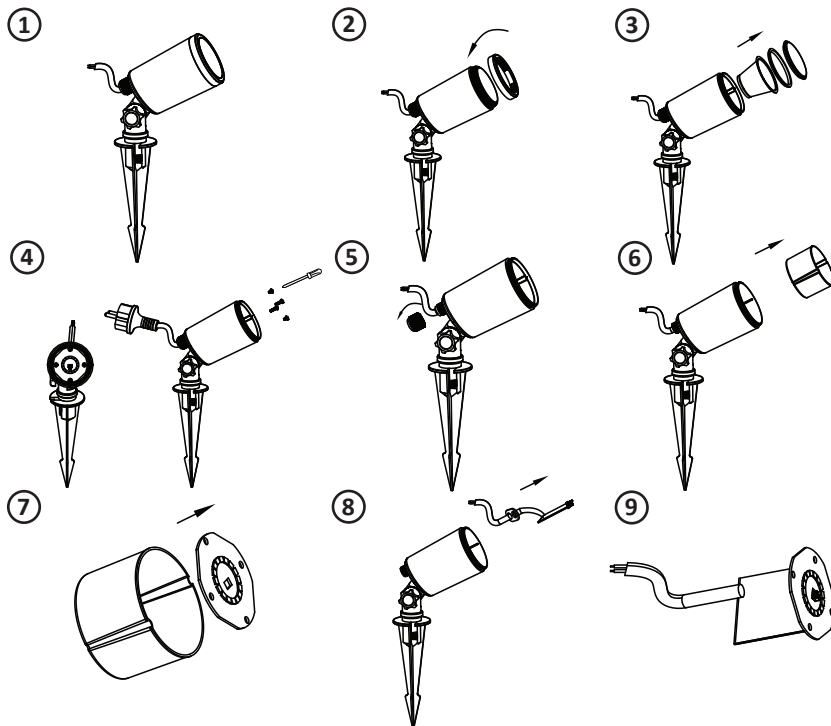

HOW TO DISSASSEMBLE THE DEVICE

1. Power off and take out a whole lamp
2. Unscrew the cover anticlockwise (there is glue on the thread of the cover, which needs to be opened with greater force)
3. Take out the lampshade, waterproof rubber ring, reflective bowl and other parts
4. Unscrew the four screws fixing the light source plate with a screwdriver
5. Unscrew the waterproof connector cap on the back of the light anticlockwise
6. Take out the waterproof joint cap and waterproof silicone rubber ring along the stripping end of the power cord
7. Take out the aluminum lamp cup with the power board
8. Take out the light source plate from the aluminum lamp cup
9. Take out the drive board with power cord from the lamp cup
10. Connect the light source board and the drive board (note that the pin should not be inserted reversely, and the arrow symbol on the light source board points to the side of the drive board where the components are attached)

Note: Dissassembling the Lamp will Void the Warranty
